

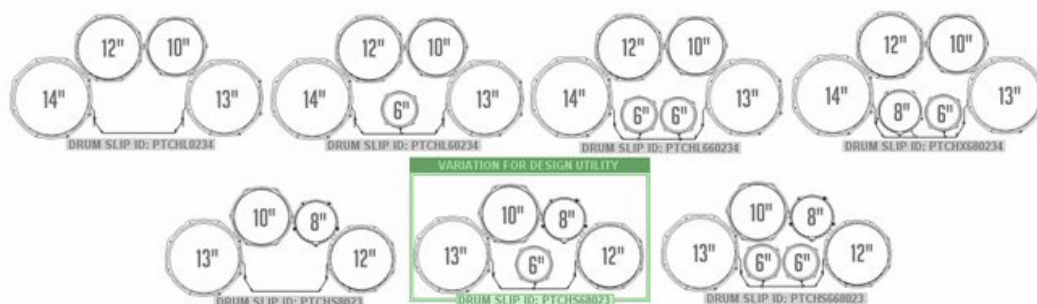

Pearl Championship Maple Tenors Drum Slip™ Installation Instructions

The instructions in this document apply to the following current model Pearl Championship Maple marching tenor drum configurations:



It is highly recommended that you read through this entire document ***BEFORE*** attempting to install Drum Slips™.

Copyright © 2013 ON2 Percussion®
DRUM SLIPS ARE PATENT PENDING
Drum Slips™ is a registered trademark of ON2 Percussion®
ON2 Percussion® is not affiliated with the Pearl Corporation
www.on2percussion.com

Step One: Preparing Your Drum for Drum Slips™



Continue to the installation process.

Step Two: Installing Drum Slips™

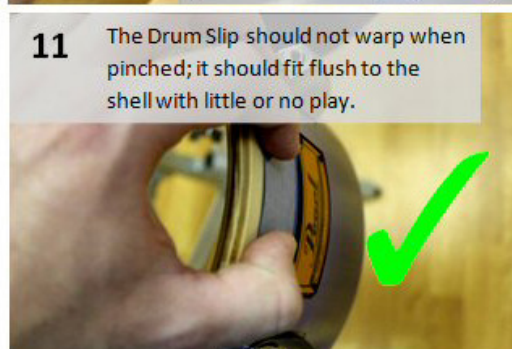
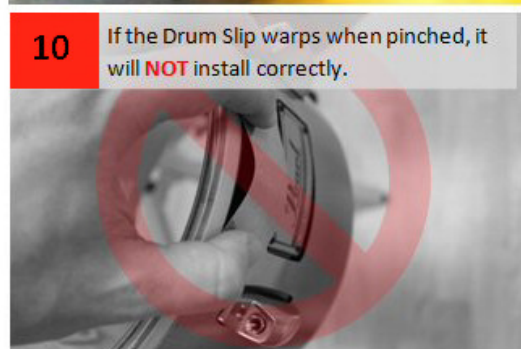
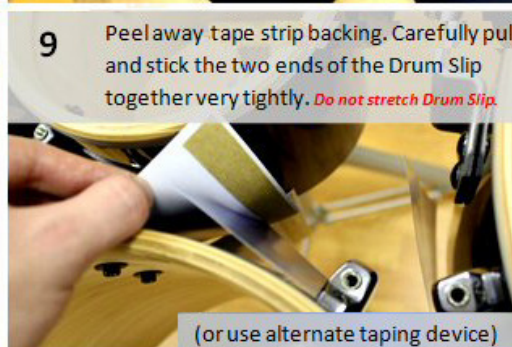
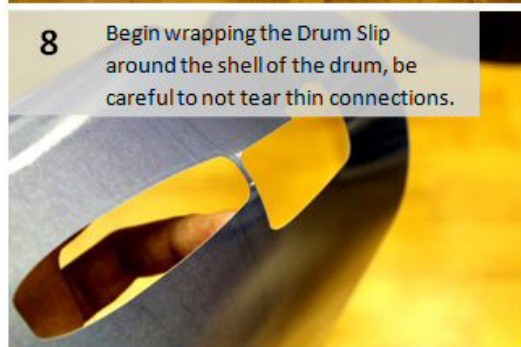
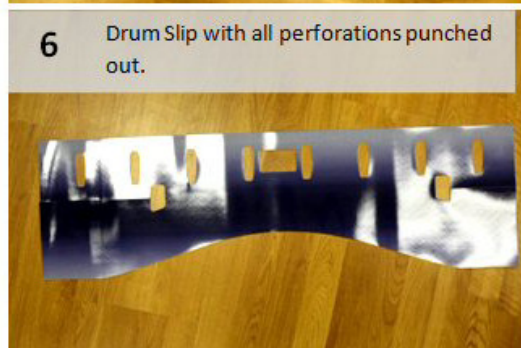
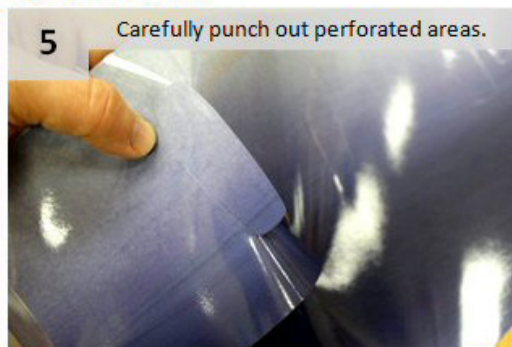
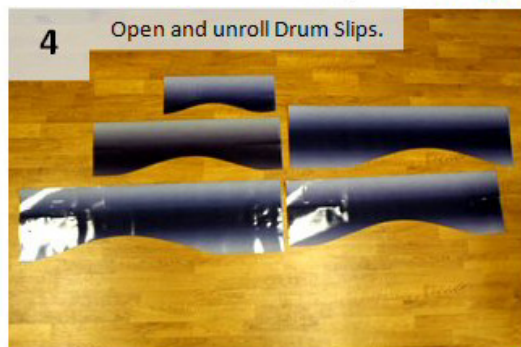

Continue to Installation Finalization

Step Three: Finalizing the installation of Drum Slips™

- 12** Drum Slips are forgiving, slide the Drum Slip around until the hardware is centered.



- 13** If desired, reinstall tom guard. Drum Slips must be installed 100% correctly with no warping play in order to reinstall tom guard. *Do not attempt to install tom guard if Drum Slips warp when pinched.*



- 14** Reinstall drum head and drum rim and apply necessary tension.

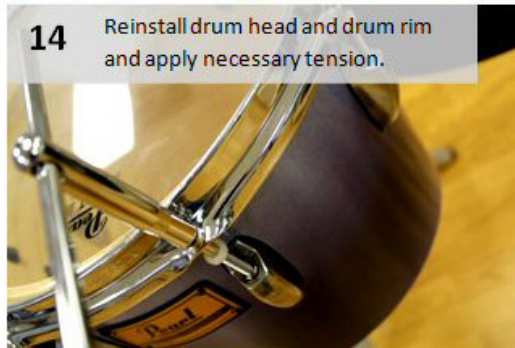

Repeat steps as necessary for all drums.

Finished

Installation Complete

