



## Pearl Championship Maple Snare Drum Slip™ Installation Instructions

The instructions in this document apply to the following current model Pearl Championship Maple marching snare drums:

FFX-1412 14" x 12" (ON2 Percussion Drum Slip ID: PSCH014)

FFX-1410 14" x 10" (ON2 Percussion Drum Slip ID: PSCH01410)

FFX-1311 13" x 11" (ON2 Percussion Drum Slip ID: PSCH013)

It is highly recommended that you read through this entire document **BEFORE** attempting to install Drum Slips™.

Copyright © 2013 ON2 Percussion®  
DRUM SLIPS ARE PATENT PENDING  
Drum Slips™ is a registered trademark of ON2 Percussion®  
ON2 Percussion® is not affiliated with the Pearl Corporation  
[www.on2percussion.com](http://www.on2percussion.com)

## Step One: Preparing Your Drum for Drum Slips™

**1** Unscrew and remove Snare Assembly.



**2** Unscrew bottom head tension lugs.



**3** Remove bottom drum head and rim.



**4** Remove drum shell.



Continue to the installation process.

## Step Two: Installing Drum Slips™

**5** Open and unroll Drum Slip.



**6** Carefully punch out perforated areas.

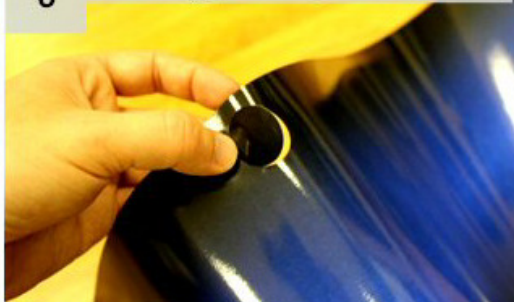

**7** Drum Slip with all perforations punched out.



**8** Place the Drum Slip on the Shell of the drum. Start by lining up the manufacturer's emblem.

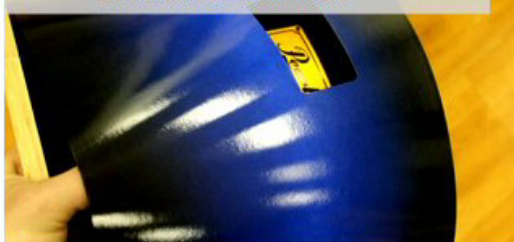

**9** Begin wrapping the Drum Slip around the shell of the drum.



**10** Peel away tape strip backing. Carefully pull and stick the two ends of the Drum Slip together very tightly. *Do not stretch Drum Slip.*

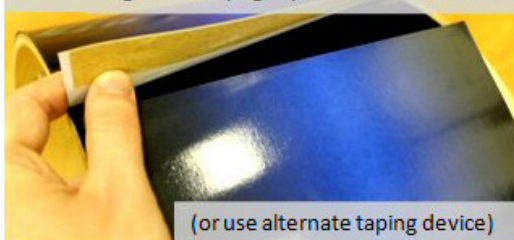

**11** If the Drum Slip warps when pinched, it will **NOT** install correctly.

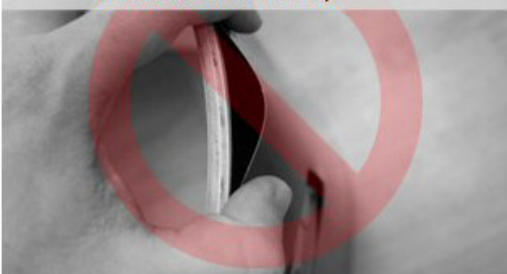

**12** The Drum Slip should not warp when pinched; it should fit flush to shell with little or no play.

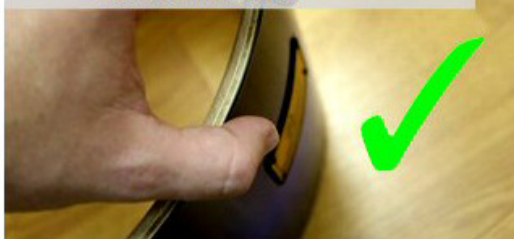

Continue to Installation Finalization



## Step Three: Finalizing the installation of Drum Slips™

- 13** Carefully insert shell back into top rim.



- 14** Place drum head and rim back on the drum.



- 15** Drum Slips are forgiving, slide the Drum Slip around until the hardware is centered.



- 16** Begin to apply necessary tension to the drum.

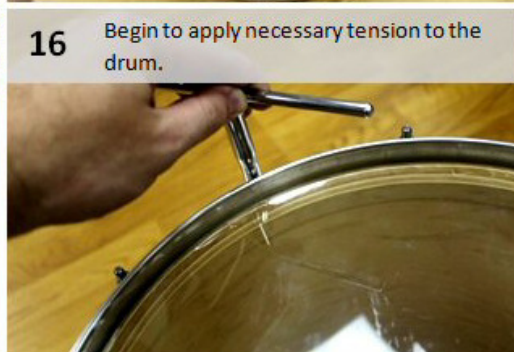

- 17** Reinstall snare strainer.

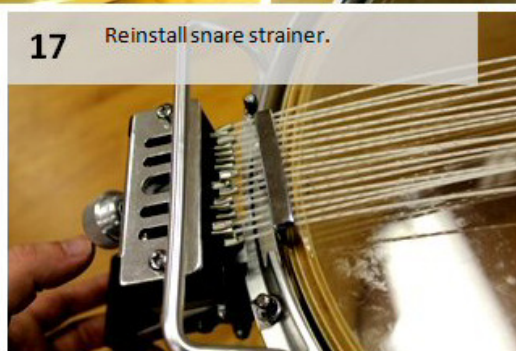

Finished

## Installation Complete

